

# V&V Reference Report

## L2 ASCDS Version : 8.4.3

Observation 13369 - L2 Version 1  
Chandra X-Ray Center

L2 Processing Date : Mar 15 2012

## Contents

<b>1</b>	<b>Front</b>	<b>2</b>
<b>2</b>	<b>OBI</b>	<b>3</b>
2.1	OBI . . . . .	3
2.1.1	Images . . . . .	3
2.1.2	Bias . . . . .	3
2.1.3	Parameters . . . . .	4
2.1.4	Events . . . . .	4
2.2	Compared Parameters . . . . .	5
2.3	Aspect . . . . .	6
2.4	Star Slots . . . . .	9
2.4.1	Slot 3 . . . . .	9
2.4.2	Slot 4 . . . . .	10
2.4.3	Slot 5 . . . . .	11
2.4.4	Slot 6 . . . . .	12
2.4.5	Slot 7 . . . . .	13
2.5	FID Slots . . . . .	14
2.5.1	Slot 0 . . . . .	14
2.5.2	Slot 1 . . . . .	15
2.5.3	Slot 2 . . . . .	16
<b>A</b>	<b>Summary</b>	<b>17</b>
A.1	Status . . . . .	17
A.2	Comments . . . . .	17

# 1 Front

seq_num	702576	Sequence number
obs_id	13369	Observation id
title	A Large, Economical Snapshot Survey of the Most-Luminous Quasars from the Sloan Digital Sky Survey	Proposal title
observer	Prof. Gordon Garmire	Principal investigator
object	SDSS J1437-0147	Source name
dtcycle	0	&#160
cycle	P	events from which exps? Prim/Second/Both
ra_targ	219.45125	Observer's specified target RA [deg]
dec_targ	-1.786306	Observer's specified target Dec [deg]
ra_nom	219.44888302406	Nominal RA [deg]
dec_nom	-1.7848273991954	Nominal Dec [deg]
roll_nom	85.346995599738	Nominal Roll [deg]
revision	1	Processing version of data
ontime	1582.842643261	Sum of GTIs [s]
livetime	1562.1616388549	Livetime [s]
ontime6	1582.8016032577	Sum of GTIs [s]
ontime7	1582.842643261	Sum of GTIs [s]
ontime8	1582.7605632544	Sum of GTIs [s]
l2events	6168	Number of level 2 events

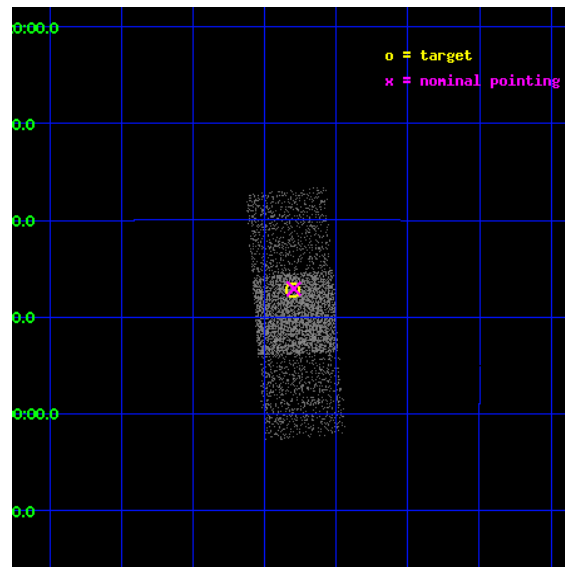

## 2 OBI

### 2.1 OBI

#### 2.1.1 Images

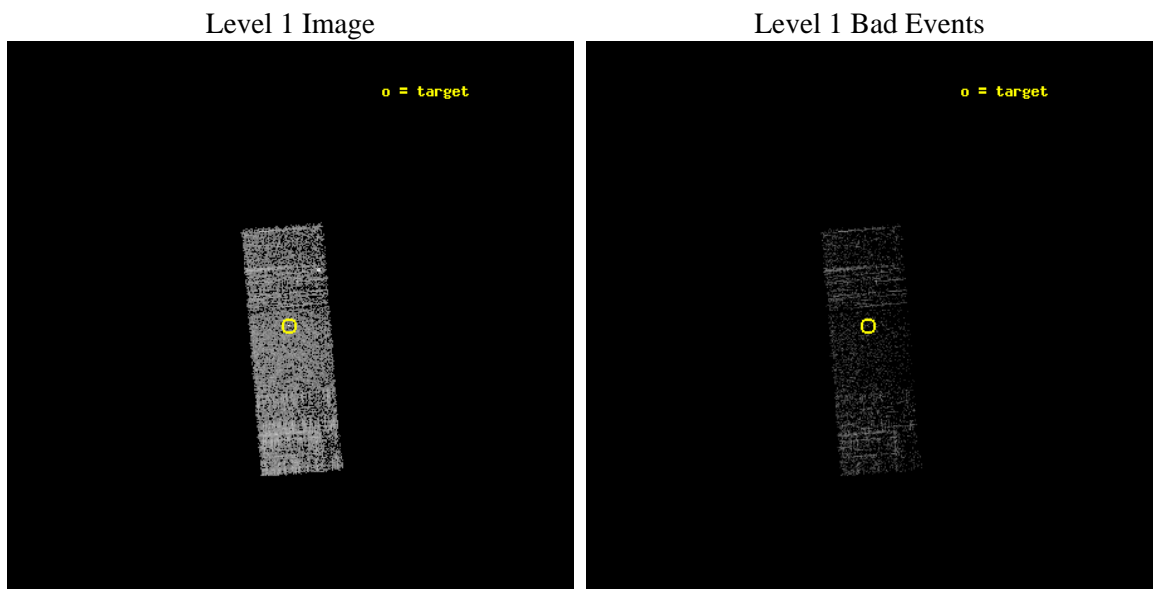

#### 2.1.2 Bias

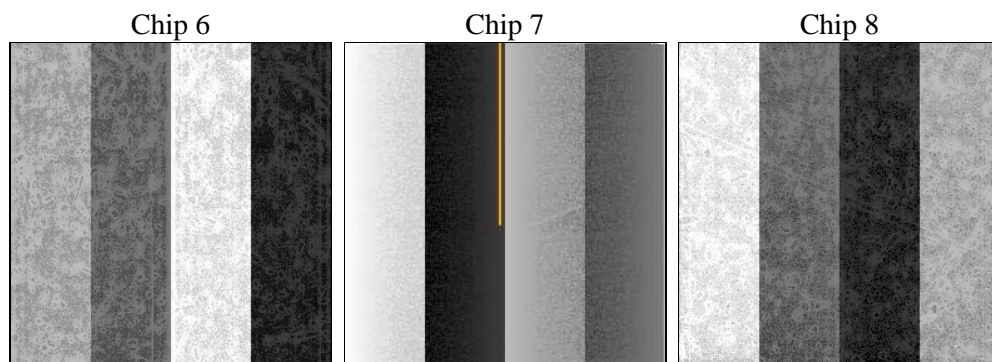

### 2.1.3 Parameters

obi_num	1	Obi number	sched_exp_time	1500.000000	[s] Scheduled observation exposure time
ascdsver	8.4.3	Processing system revision	ontime	1582.842643261	Sum of GTIs [s]
caldsver	4.4.8	&#160	ontime6	1582.8016032577	Sum of GTIs [s]
date	2012-03-15T17:18:09	Date and time of file creation	ontime7	1582.842643261	Sum of GTIs [s]
revision	1	Processing version of data	ontime8	1582.7605632544	Sum of GTIs [s]
			l1events	30481	Number of level 1 events

### 2.1.4 Events

	<b>ccd 6</b>	<b>ccd 7</b>	<b>ccd 8</b>
level 1 events	8496	9042	12943
rejected events	6969	4554	8016
rejected %	82%	50%	61%

	<b>ccd 6</b>	<b>ccd 7</b>	<b>ccd 8</b>
grade 0 events	875	466	1443
	10%	5%	11%
grade 1 events	9	10	13
	0%	0%	0%
grade 2 events	248	965	916
	2%	10%	7%
grade 3 events	107	427	723
	1%	4%	5%
grade 4 events	103	410	677
	1%	4%	5%
grade 5 events	323	925	507
	3%	10%	3%
grade 6 events	197	2229	1168
	2%	24%	9%
grade 7 events	6634	3610	7496
	78%	39%	57%

## 2.2 Compared Parameters

Parameter	Planned	Actual	Parameter	Planned	Actual
Instrument	ACIS	ACIS	Obspar format version number	7	7
Detector	ACIS-678	ACIS-678	Obspar file type	PREDICTED	ACTUAL
Grating	NONE	NONE	Obspar update status	NONE	UPDATED
Data mode	VFAINT	VFAINT	Number of optional ACIS chips dropped	0	0
Observation mode	POINTING	POINTING	On-chip summing requested	N	N
[deg] Pointing RA	219.460880	219.4488830240582	Subarray requested	NONE	NONE
[deg] Pointing Dec	-1.809023	-1.784827399195445	Alternating exposures requested	N	N
[deg] Pointing Roll	85.190823	85.34699559973826	[s] Primary exposure time	0.000000	3.1
[mm] SIM focus pos	-0.684267	-0.6828225247311905			
[mm] SIM defocus	0	0.001444936568705701			
[mm] SIM translation stage pos	-190.132523	-190.145094680475			
[mm] SIM translation stage offset	0	0.01257209746719923			
[s] Observation start time (MET)	448186193.184000	448185199.24816			
Observation start date	2012-03-15T08:08:47	2012-03-15T07:53:19			
[s] Observation end time (MET)	448187693.184000	448188388.02333			
Observation end date	2012-03-15T08:33:47	2012-03-15T08:46:28			
Read mode	TIMED	TIMED			

## 2.3 Aspect

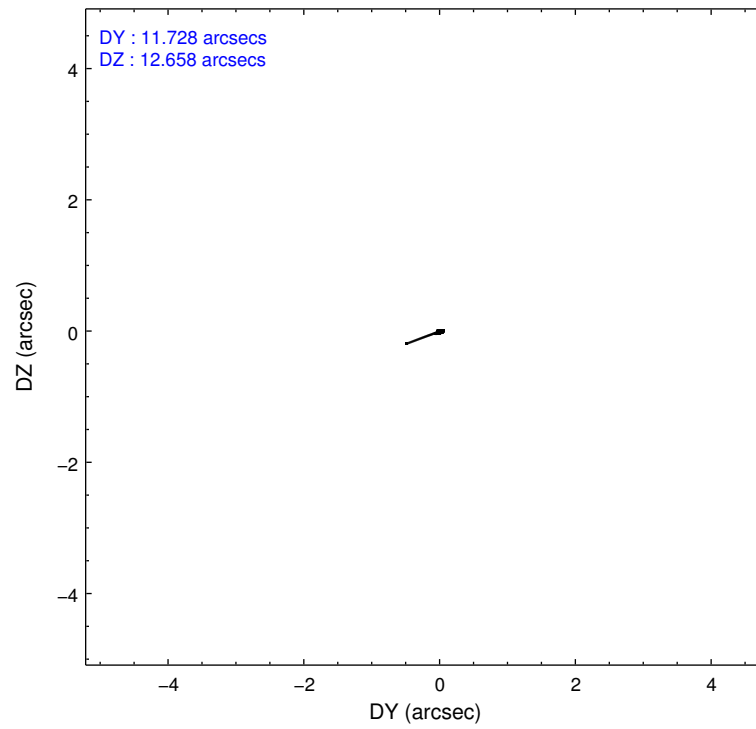
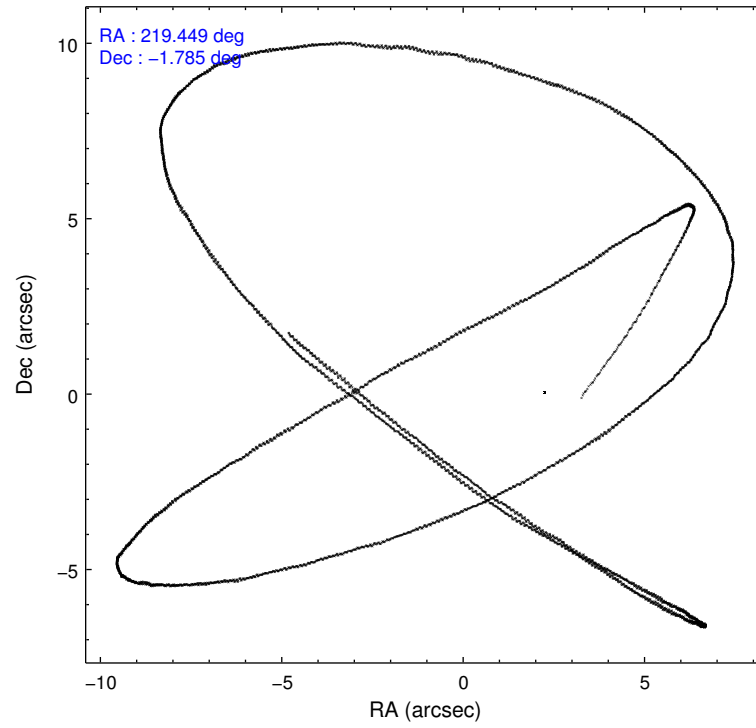

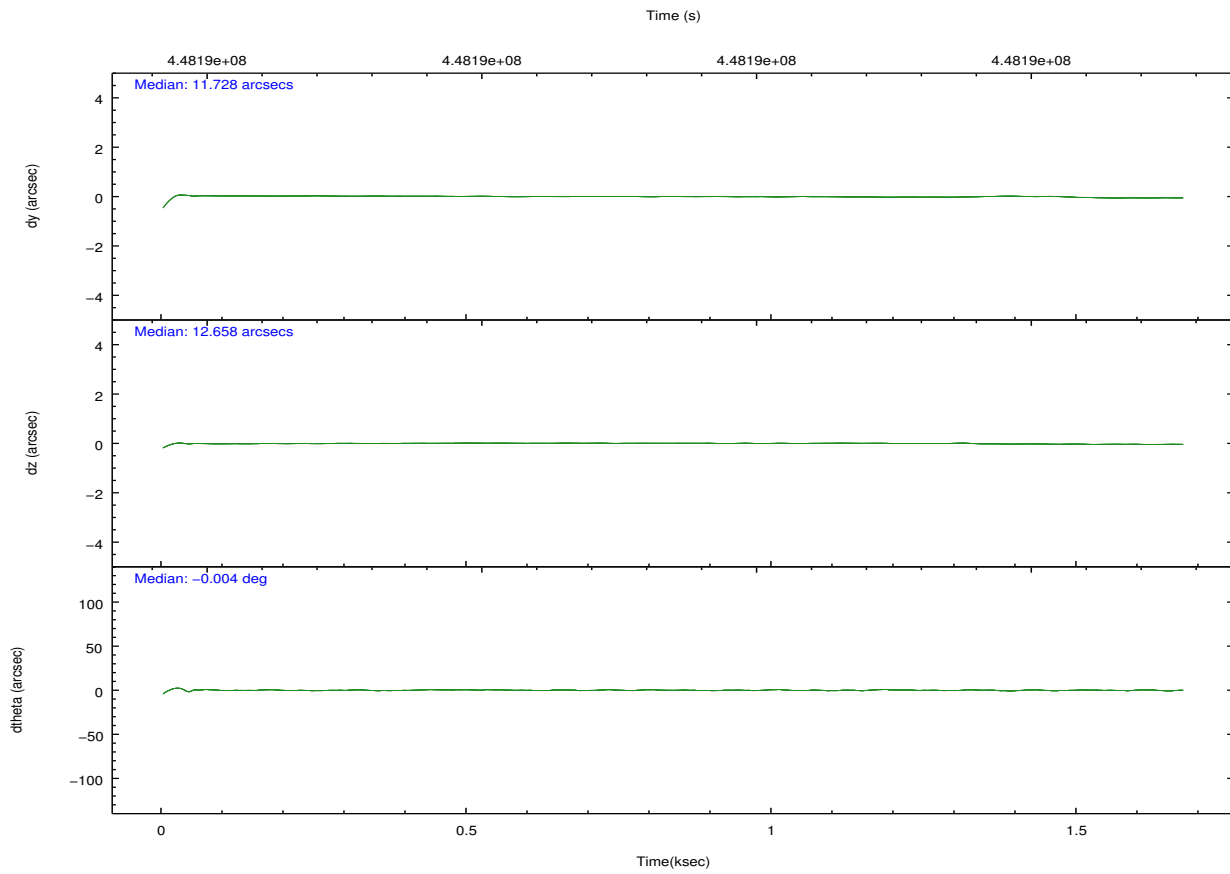
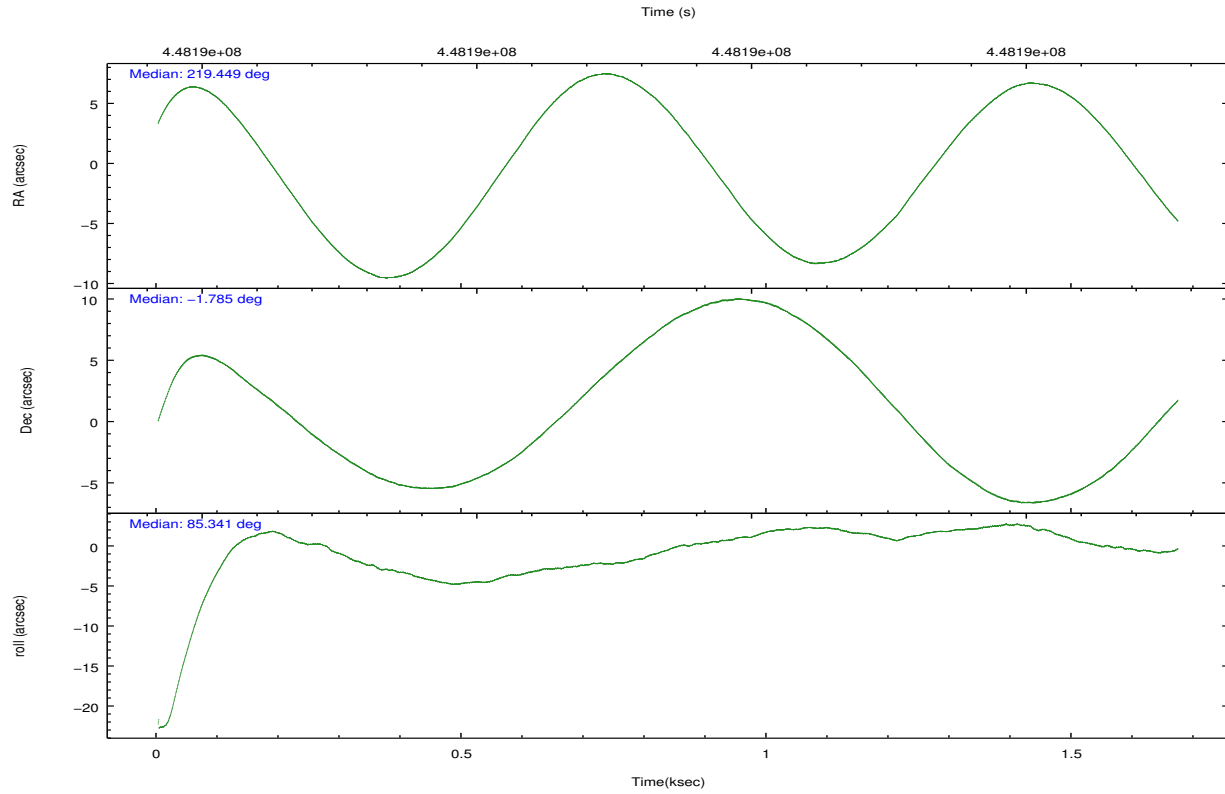

### Slot Statistics

slot	status	id	mag	n_pts	med_dy	med_dz	dr1	dr2	ra	dec	mean_y	mean_z
0	FID	ACIS-S-2	7.00	408	-0.050	-0.037	0.006	0.011	0.000000	0.000000	-764.67	-1733.90
1	FID	ACIS-S-4	7.10	406	0.168	0.034	0.005	0.010	0.000000	0.000000	2147.03	170.53
2	FID	ACIS-S-5	7.13	408	-0.149	0.012	0.007	0.012	0.000000	0.000000	-1812.53	168.72
3	GUIDE	653398032	9.62	816	-0.119	0.163	0.181	0.297	220.061352	-1.385536	1701.55	-2024.72
4	GUIDE	653398544	10.12	813	-0.019	0.077	0.214	0.346	219.903444	-1.208499	2287.42	-1408.63
5	GUIDE	653793024	9.67	816	0.061	-0.301	0.209	0.318	218.917271	-2.072370	-1105.04	1867.79
6	GUIDE	653793192	10.05	817	0.149	-0.237	0.157	0.273	218.947968	-2.312766	-1962.32	1689.48
7	GUIDE	653920912	8.27	816	-0.070	0.303	0.086	0.132	219.700165	-2.286522	-1641.62	-999.03



## 2.4 Star Slots

### 2.4.1 Slot 3

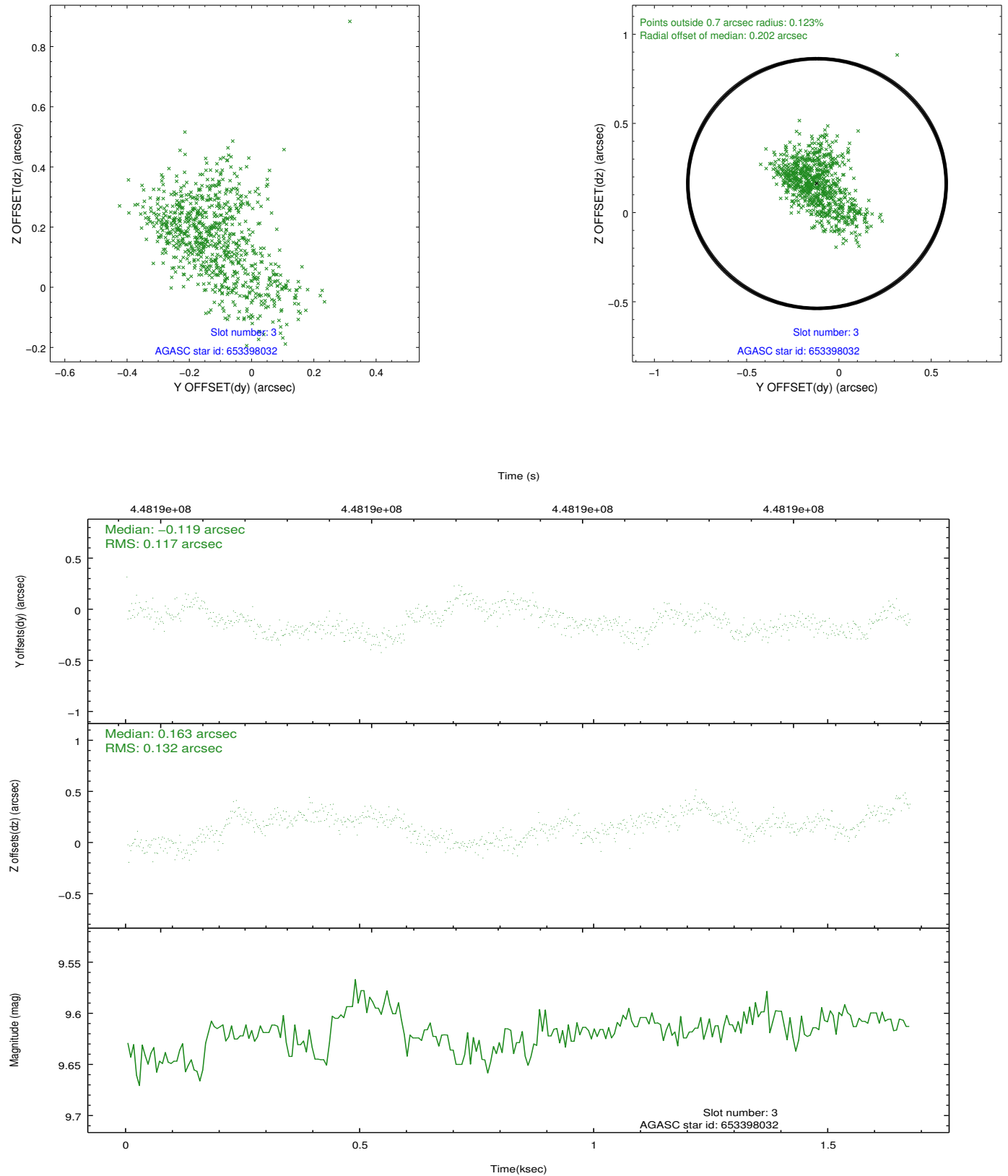

## 2.4.2 Slot 4

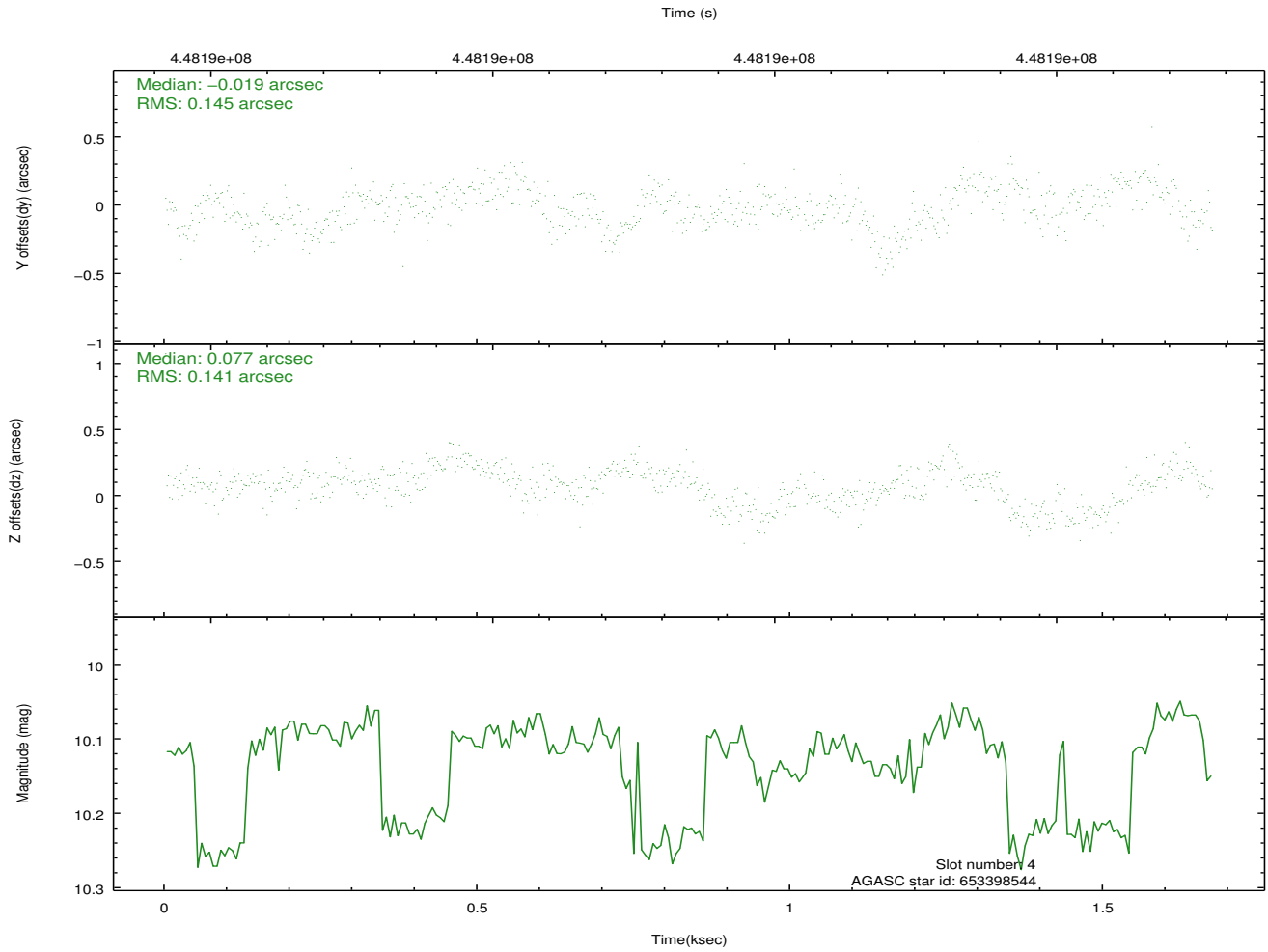
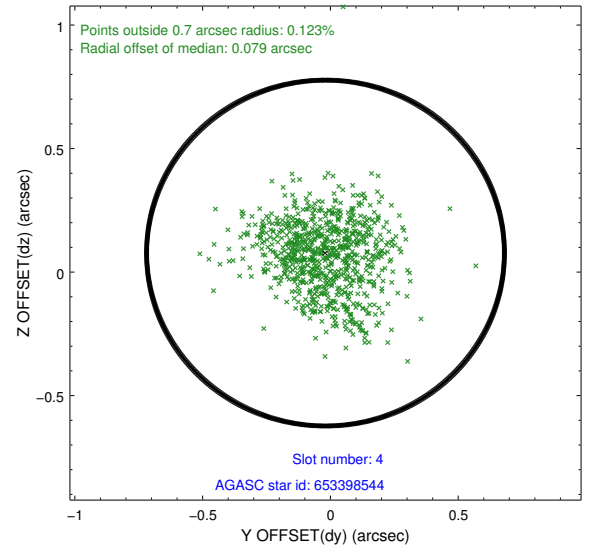
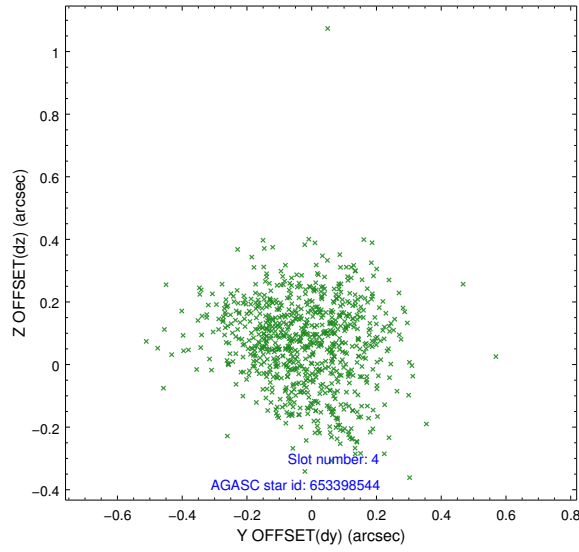

### 2.4.3 Slot 5

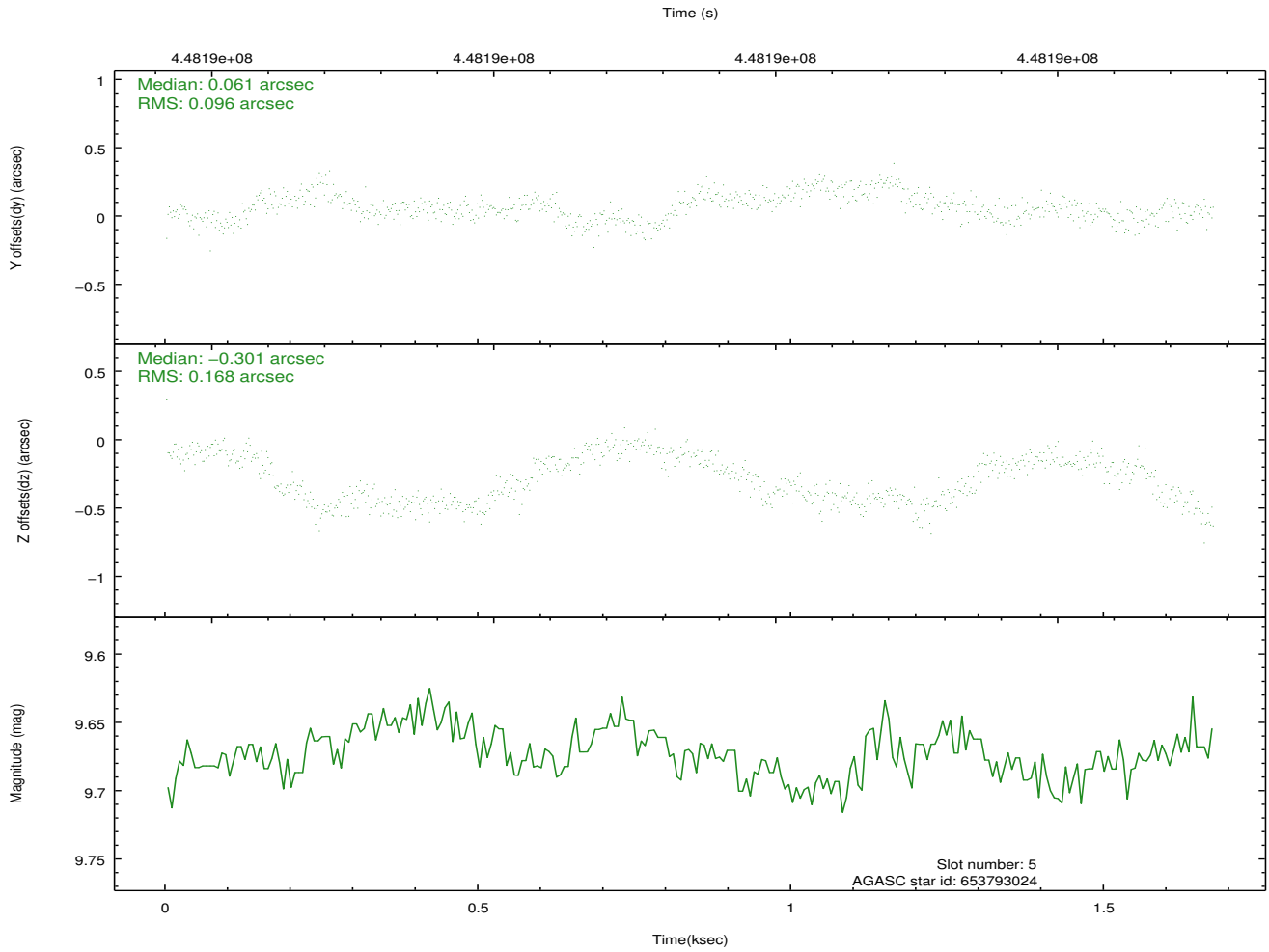
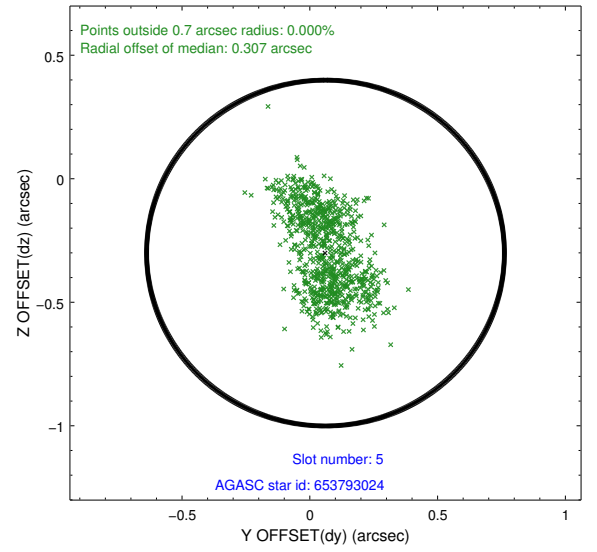
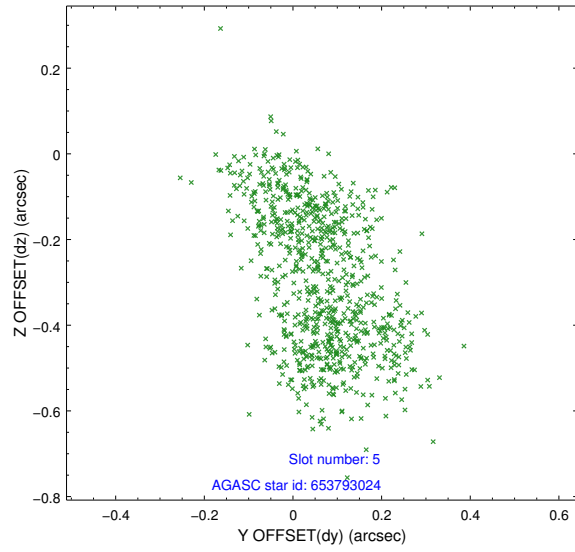

## 2.4.4 Slot 6

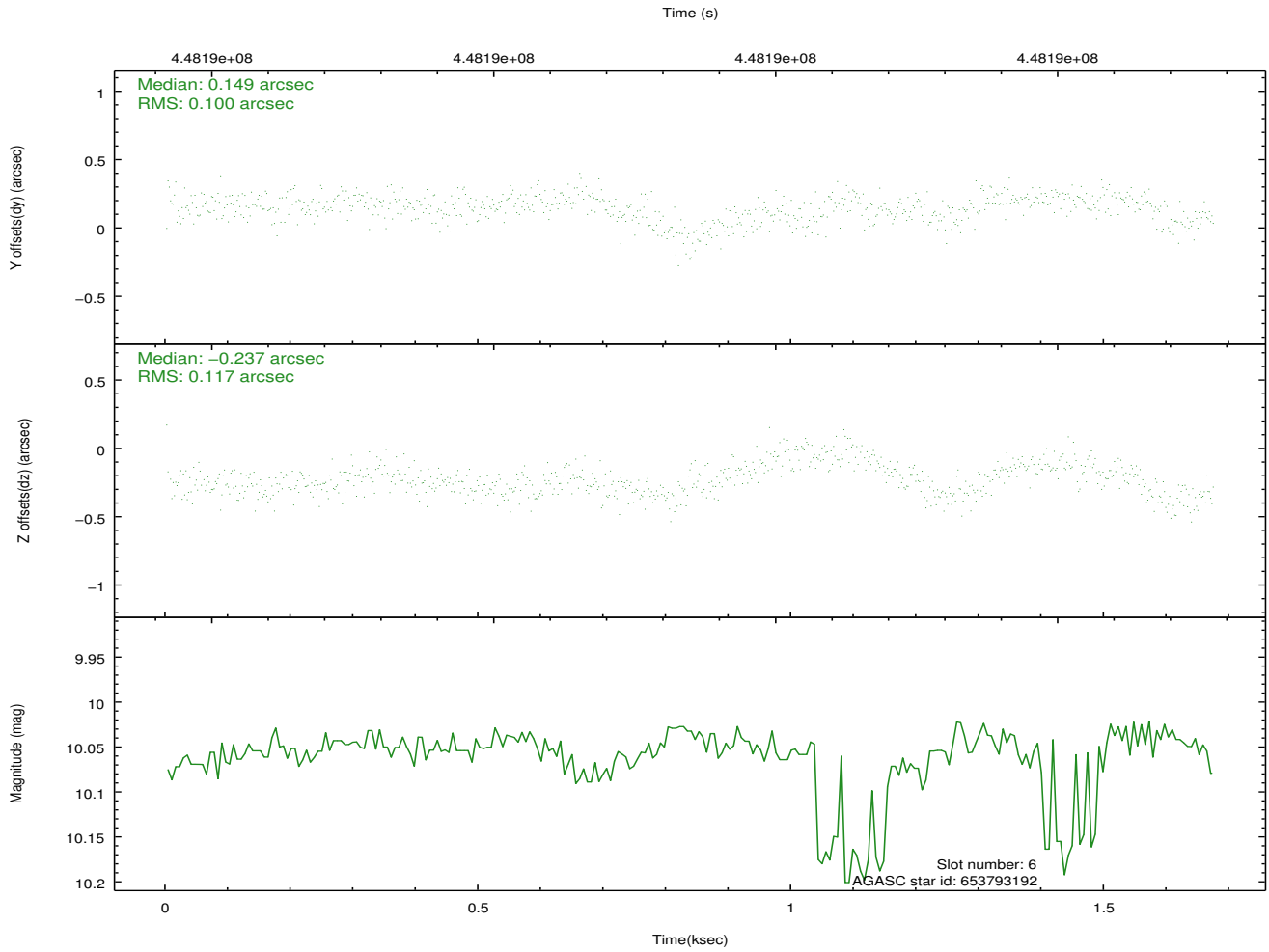
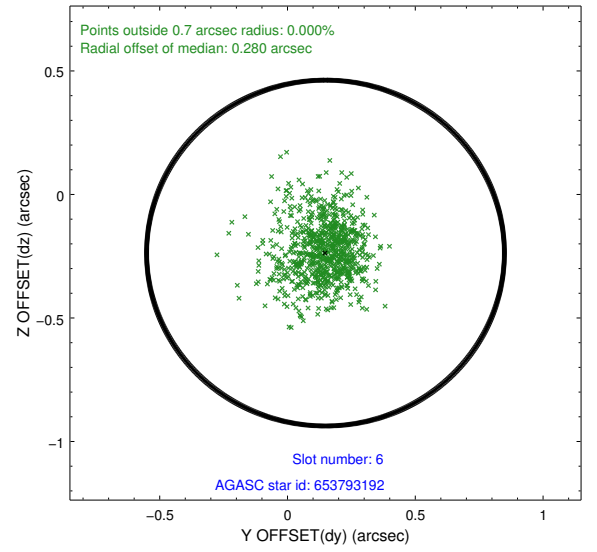
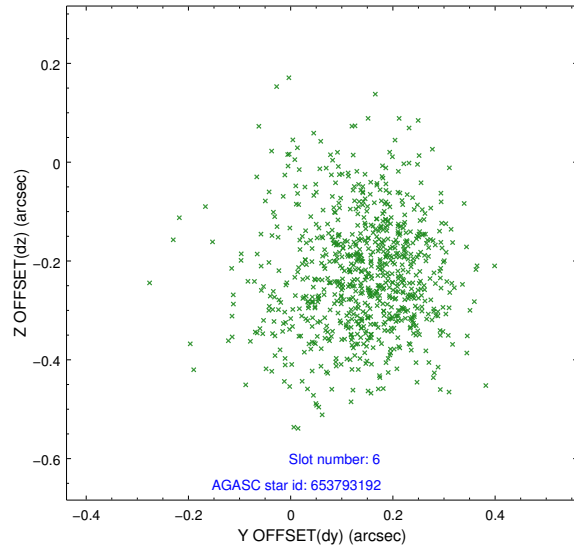

## 2.4.5 Slot 7

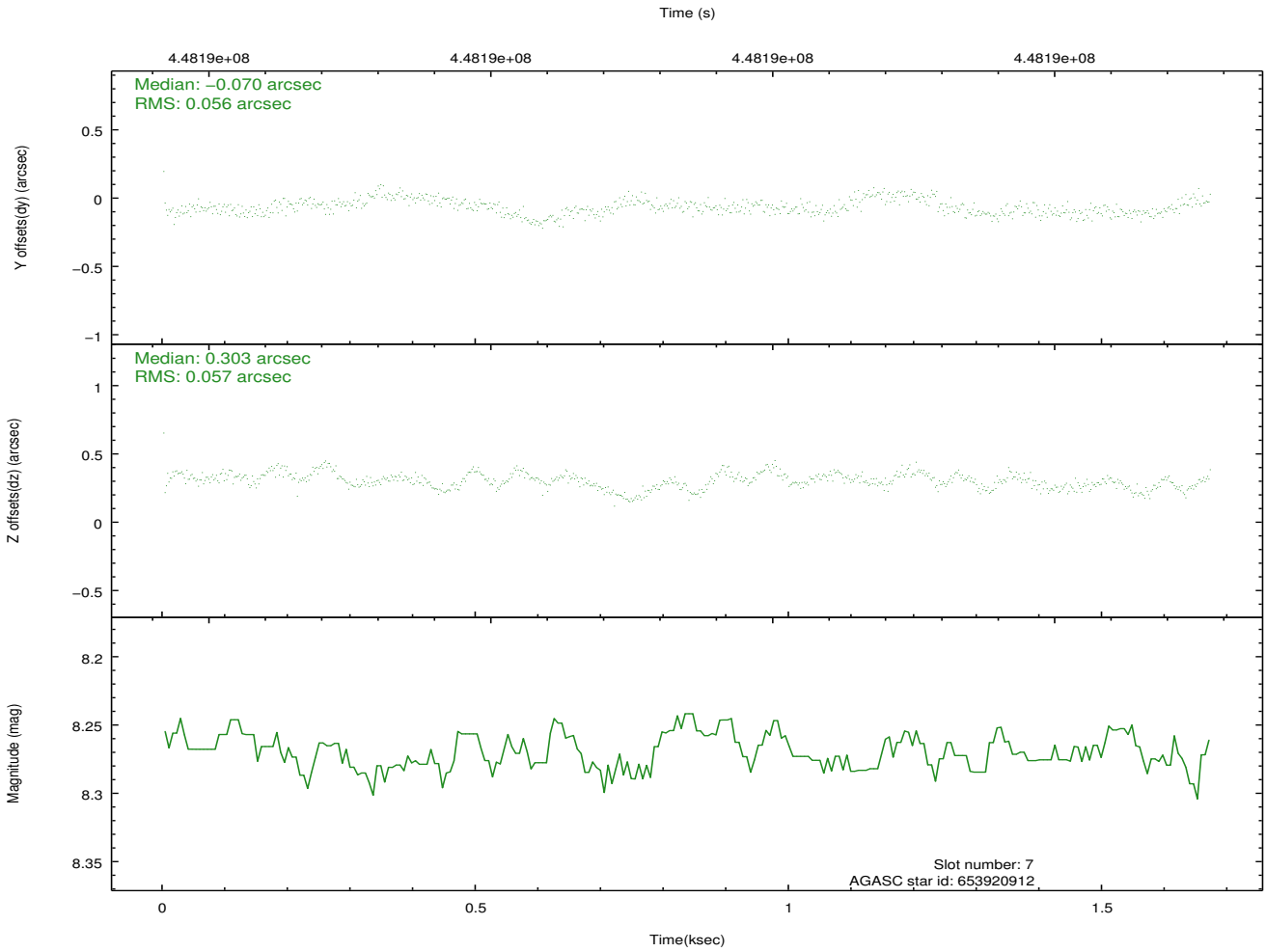
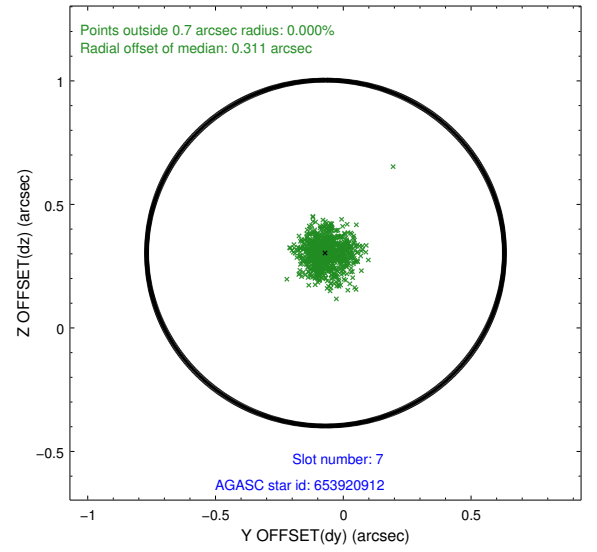
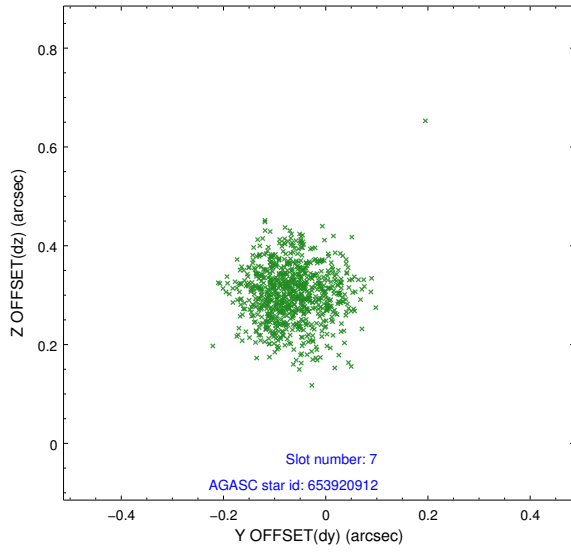

## 2.5 FID Slots

### 2.5.1 Slot 0

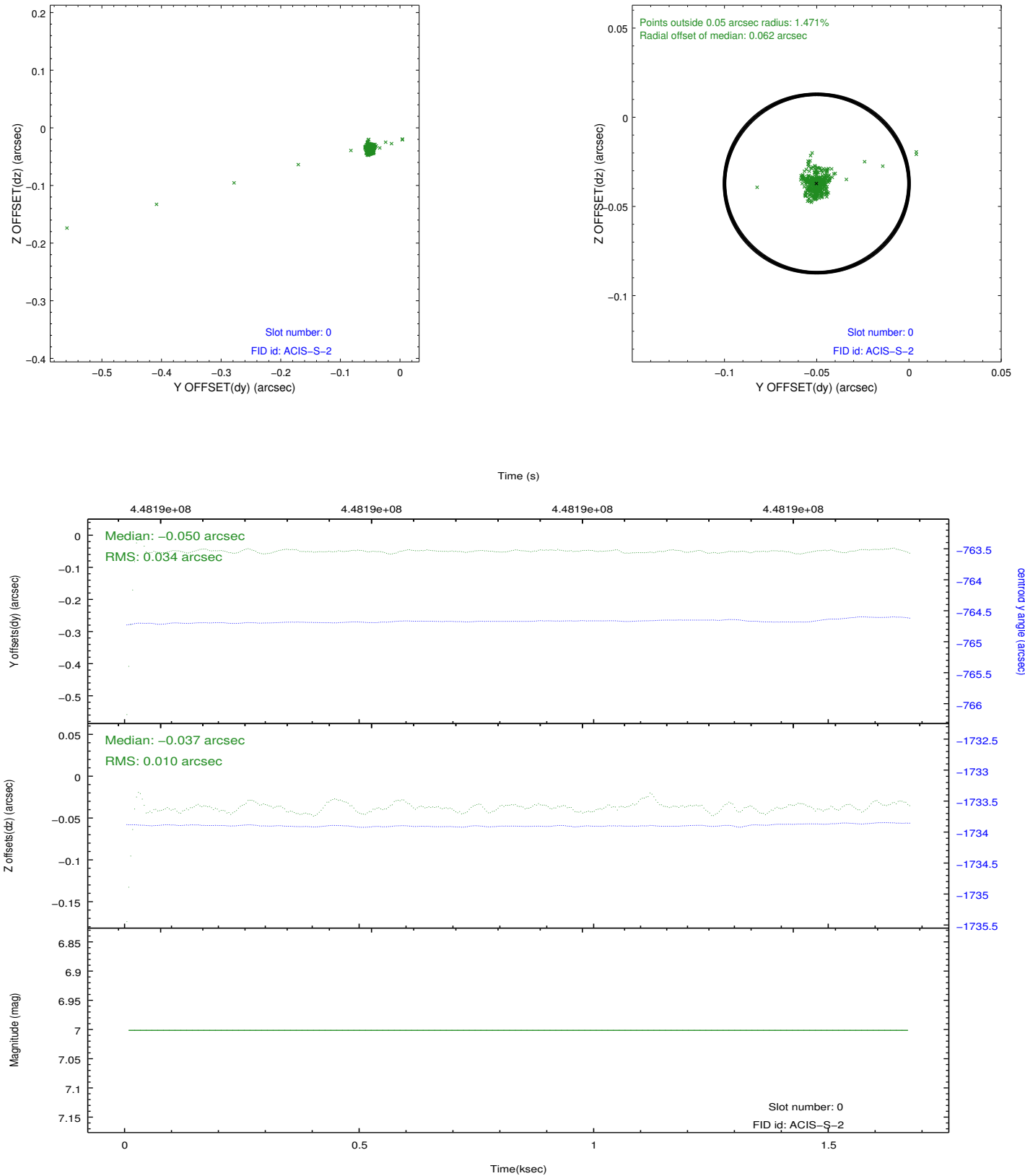

## 2.5.2 Slot 1

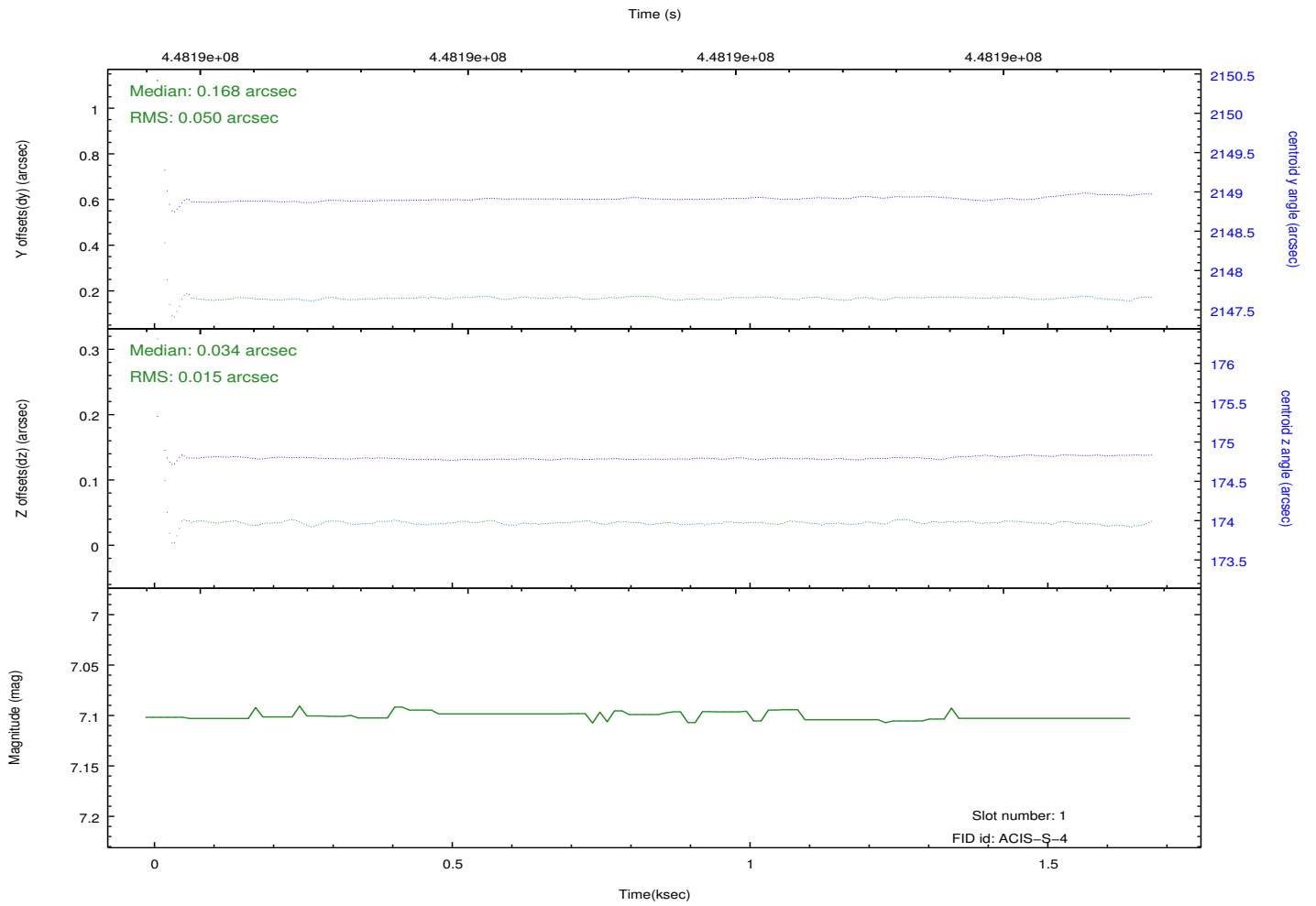
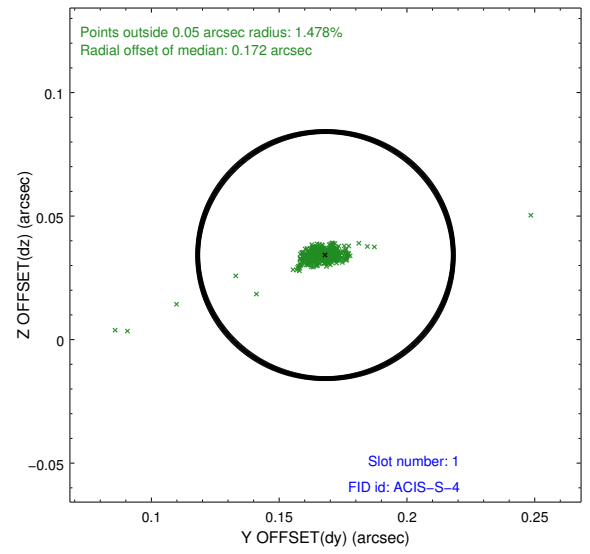
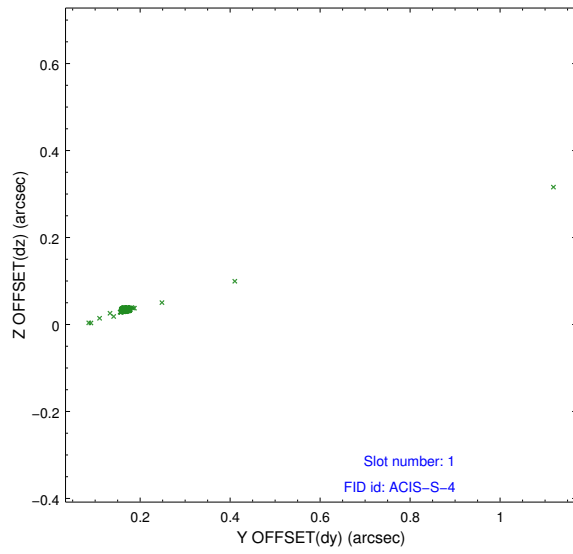

### 2.5.3 Slot 2

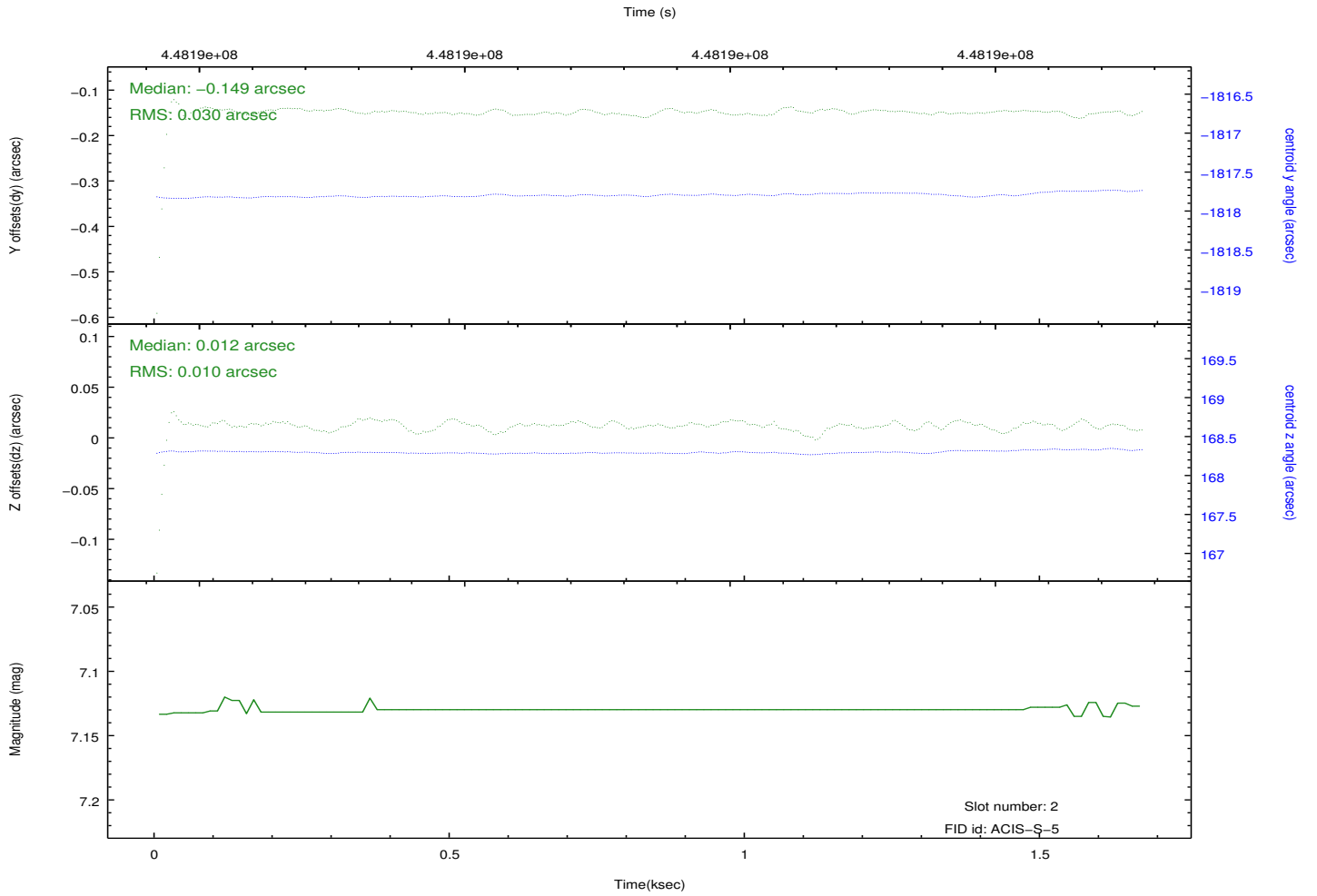
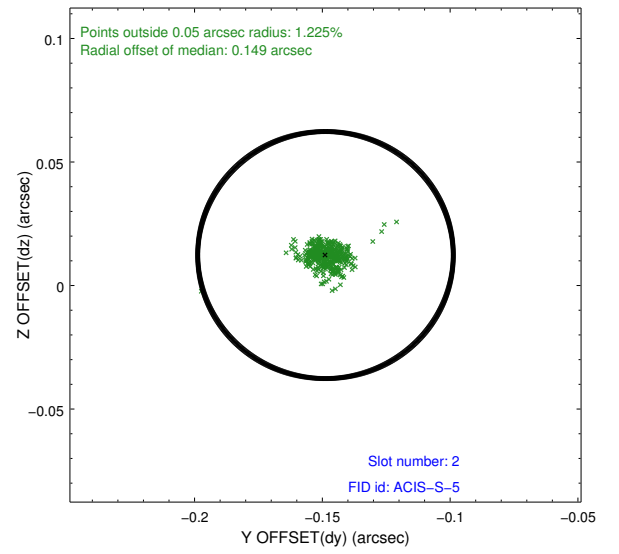
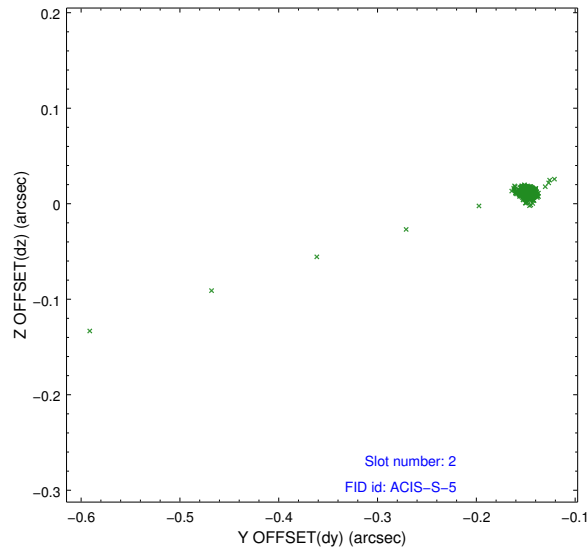



## A Summary

### A.1 Status

V&V Scientist	Beth Sundheim
V&V Date (YYYY-MM-DD)	2012.03.15
V&V Edition	1
V&V Disposition and Status	OK
V&V Charge Time	1.582842643261

### A.2 Comments